

S210 3 -IN-1 ROLLER STAND

TOUGHBUILT.

OPERATOR'S MANUAL ENGLISH

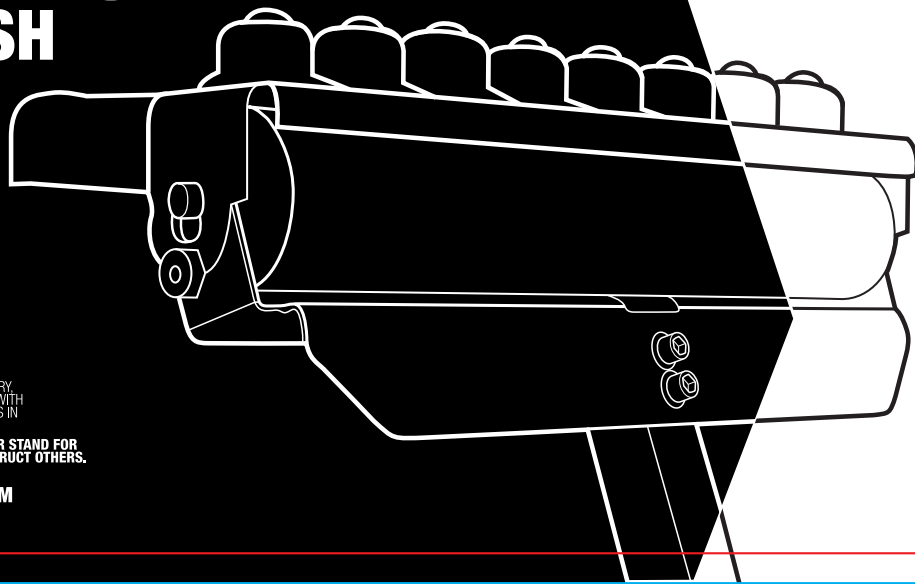

! WARNING

TO REDUCE RISK OF SERIOUS INJURY,
THOROUGHLY READ AND COMPLY WITH
ALL WARNINGS AND INSTRUCTIONS IN
THIS MANUAL AND ON PRODUCT.

**KEEP THIS MANUAL NEAR YOUR STAND FOR
EASY REFERENCE AND TO INSTRUCT OTHERS.**

© COPYRIGHT 2016 TOUGHBUILT INDUSTRIES INC.

WWW.TOUGHBUILT.COM

TB-S210

TABLE OF CONTENTS

► Safety Symbols	01
► Safety	02
► Features	03
► Parts List & Tools Needed	04
► Bolts, Nuts, Washers	05
► Assembly Instructions	06
► Adjustment Instructions	07
► Transporting & Storing	08
► Maintenance & Notes	08

SAFETY SYMBOLS

Some of the following symbols may be used on your tool. Please study them and learn their meaning. Proper interpretation of these symbols will allow you to operate the tool better and safer.



This symbol designates that this tool is listed by Underwriters Laboratories, to United States and Canadian Standards.



This symbol designates that this tool is listed by Underwriters Laboratories.



This symbol designates that this tool is listed by the Intertek Testing Services, to United States and Canadian Standards.



This symbol designates that this tool is listed by the Canadian Standards Association, to United States and Canadian Standards.



This symbol designates that this tool is listed by the Canadian Standards Association.

SYMBOL	NAME	DESIGNATION / EXPLANATION
V	Volts	Voltage
A	Amperes	Current
Hz	Hertz	Frequency (cycles per second)
W	Watts	Power
~	Alternating current	Type of current
==	Direct current	Type of characteristic of current
n0	No-load speed	Rotational speed, at no load
lbs	Pounds	Weight
	Class II Construction	Double-insulated Construction
	Wear gloves	Wear gloves to reduce risk of injury
	Warning symbols	Alerts used for warning messages
.../min	Per minute	Revolutions, strokes, surface speed orbits, etc. per minute
	Read the operator's Manual	To reduce the risk or injury, read and understand operator's manual
	Wear safety glasses	Operation of power tool can result in foreign objects being thrown into eyes
	Wear respiratory protection	Use of this tool can generate dust which may cause respiratory injury
	Wear hearing protection	Noise from this product can contribute to hearing loss

The purpose of safety symbols is to attract your attention to possible dangers. The safety symbols, and explanations with them, deserve your careful attention and understanding. The symbol warnings do not by themselves eliminate any danger. The instructions and warnings they give are no substitutes for proper accident prevention measures.

! WARNING

BE SURE TO READ AND UNDERSTAND ALL SAFETY INSTRUCTIONS IN THIS MANUAL, INCLUDING ALL SAFETY ALERT SYMBOLS SUCH AS "DANGER", "WARNING" AND "CAUTION", BEFORE USING THIS POWER TOOL. FAILURE TO FOLLOW ALL INSTRUCTIONS LISTED BELOW MAY RESULT IN ELECTRIC SHOCK, FIRE AND/OR SERIOUS PERSONAL INJURY.



Safety alert symbol: Indicates DANGER, WARNING, or CAUTION. May be used in conjunction with other symbols or pictographs.

! DANGER

Failure to obey this warning **WILL** result in death or serious injury to you or to others. Always follow the safety precautions to reduce the risk of fire, electric shock and personal injury.

! WARNING

Failure to obey this safety warning **CAN** result in death or serious injury to you or to others. Always follow the safety precautions to reduce the risk of fire, electric shock personal injury.

! CAUTION

Failure to obey this safety warning **MAY** result in personal injury to you or others or property damage. Always follow the safety precautions to reduce the risk of fire, electric shock and personal injury.

SAFETY

GENERAL SAFETY INSTRUCTIONS FOR POWER TOOLS

Using power tools of any kind can be dangerous if safe operating procedures are not followed. Recognizing the hazards of each tool and using them with respect and caution will considerably limit the possibility of personal injury. However, if safety precautions are ignored, personal injury will likely result. Always use common sense; your personal safety is your responsibility.

1. Know your power tool. Read and understand the Operator's Manual and observe the warnings and instruction labels affixed to the tool.
2. Properly ground all tools.
3. Keep guards in place.
4. Remove adjusting keys and wrenches.
5. Keep work area clean and dry.
6. Keep children away.
7. Never leave running machines/tools unattended.
8. Disconnect tools for service.
9. Use correct tools for the job.
10. Never force a tool.
11. Wear safety apparel.
12. Wear safety glasses/goggles.
13. Never stand or sit on tools.

SAFETY

14. Replace damaged components immediately.
15. Make sure your work platform is sufficiently sturdy to do the specific job at hand.
16. Properly anchor blade for job being done.
17. Use correct blade for job being done.
18. Think Safety. Safety is a combination of operator awareness, common sense and alertness at all times.

SAFETY INSTRUCTIONS

1. Use caution when folding or unfolding legs to limit any finger pinch points.
2. Place stand on flat and level surface to keep from rocking or tipping.
3. Make sure that work support extensions are within safe operating limits, and are properly locked in place before using tool.
4. Test the setup for stability before proceeding with work.

FEATURES

You have just purchased a S210 3-in-1 Roller Stand. This product has been specifically designed to assist you in the use of your 10-12" (25-30cm) miter saw, as well as increasing efficiency with other bench top tools such as table saws, band saws, scroll saws, planers, etc.

Your S210 3-in-1 Roller Stand is loaded with standard features all designed and engineered to maximize the functionality and flexibility of your Miter Saw Stand.

- Quickly adjust height from 27.5"-43.5".
- Folds flat for easy storage.
- Galvanized steel rollers provide support & smooth movement.
- 3-in-1 head adjusts to use ball bearings, roller or sliding plate.
- 2" box tube frame creates an extremely strong structure.
- Custom feet keep stand stable and secure.
- Heavy-duty steel construction provides strength and support

PART LISTS

Description	Part Number	Qty.
1 Extension Bar	TB-S210-P-001	1 pc
2 Stand Assembly	TB-S210-P-002	1 pc
3 30x30 Rectangle Foot	TB-S210-P-003	1 pc
4 50x30 Rectangle Foot	TB-S210-P-004	1 pc
5 3-in-1 Roller Head	TB-S210-P-005	1 pc
6 Locking Handle	TB-S210-P-006	1 pc

Description	Part Number	Qty.
7 M6x35 Inside Hex Bolt	TB-S210-P-007	2 pcs
8 M6x45 Inside Hex Bolt	TB-S210-P-008	4 pcs
9 Ø6 Flat Washer	TB-S210-P-009	6 pcs
10 M6 Lock Nut	TB-S210-P-010	2 pcs
11 Ø6 Spring Washer	TB-S210-P-011	4 pcs

**PARTS MAY CHANGE WITHOUT FURTHER NOTICE.

TOOLS NEEDED



BOLTS, NUT, WASHERS

7 M6x35 Inside Hex Bolt 2 pcs

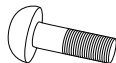

8 M6x45 Inside Hex Bolt 4pcs

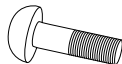

9 Ø6 Flat Washer 6 pcs



10 M6 Lock Nut 2 pcs



11 Ø6 Spring Washer 4 pcs

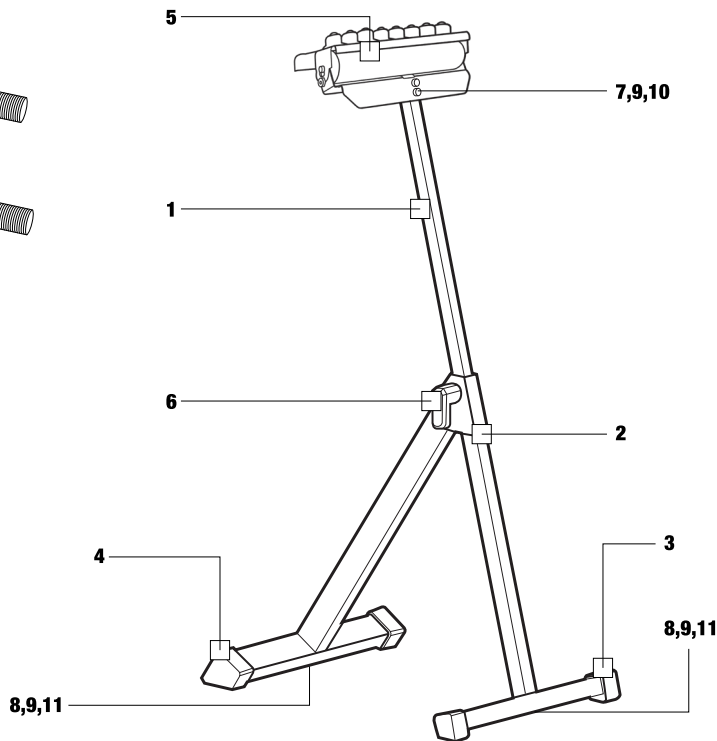

ASSEMBLY INSTRUCTIONS

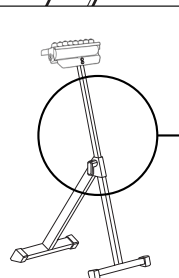
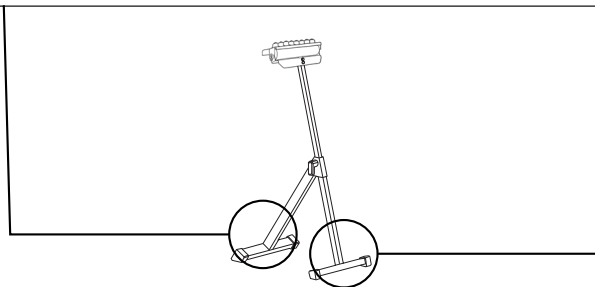
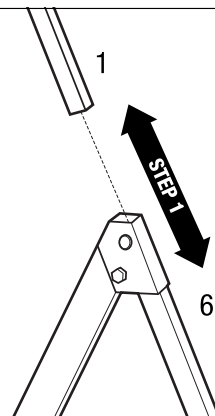
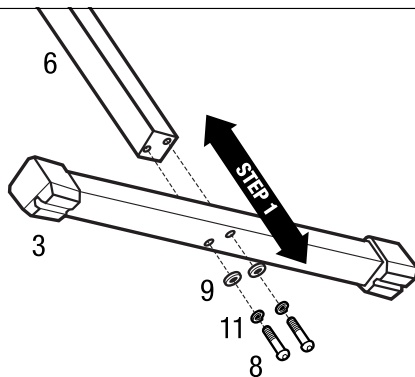
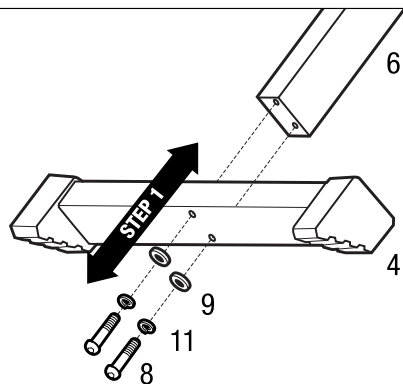

ADJUSTMENT INSTRUCTIONS

QUICKLY ADJUST HEIGHT
from 27.5" - 43.5"

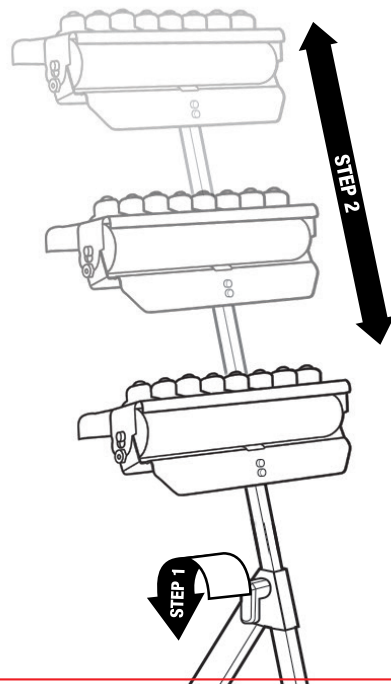
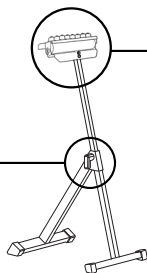
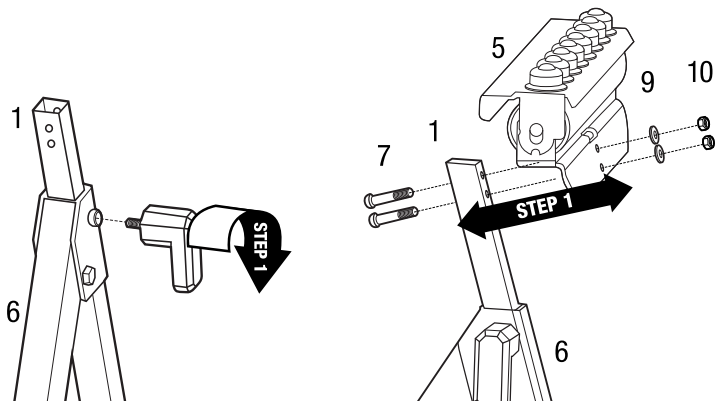

TRANSPORTING & STORING

FOLDS FLAT for easy storage

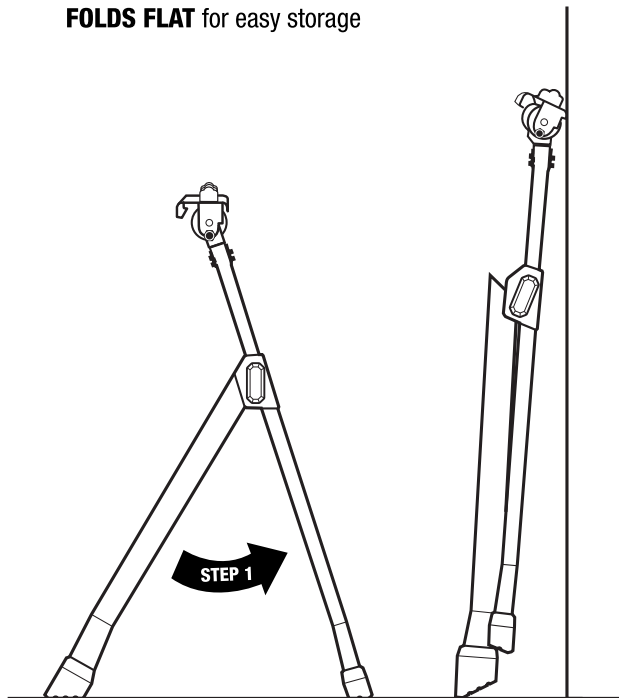

MAINTENANCE

Avoid using solvents when cleaning plastic parts. Most plastics are susceptible to damage from various types of commercial solvents and may be damaged by their use. Use clean cloth to remove dirt, dust, oil, grease, etc.

NOTES

This image shows a single sheet of white paper with horizontal blue or grey ruling lines. The lines are evenly spaced and run across the width of the page. There are approximately 20 lines visible. The paper has a slight shadow on its right side, suggesting it's resting on a surface.

**QUALITY
GUARANTEED**



FOR PRODUCT INFORMATION AND WARRANTY REGISTRATION VISIT

WWW.TOUGHBUILT.COM

TOUGHBUILT
TB-S210 

© COPYRIGHT 2017 TOUGHBUILT INDUSTRIES INC.